

Pickit XL-HD2

facts

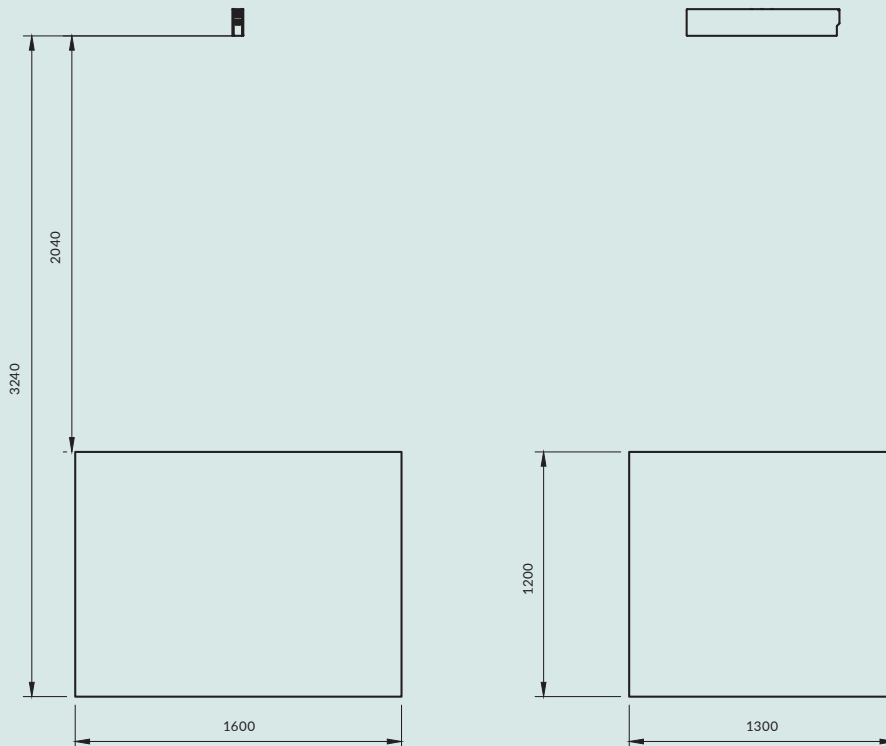
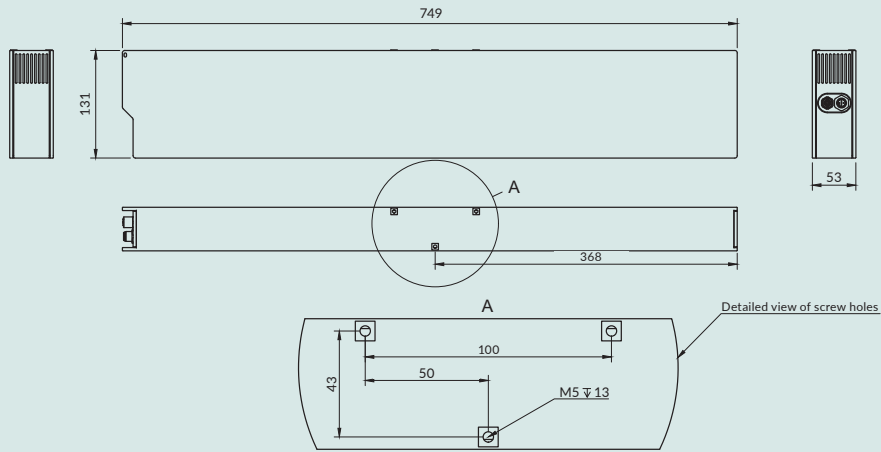

Dimensions in mm

Scan QR code
for more





CAMERA TECHNICAL SPECIFICATIONS

3D measurement method	Laser triangulation
3D image capturing time	from 400 ms
3D camera resolution (pixels)	2448 x 2064
3D camera accuracy*	2-4mm
Estimated picking accuracy**	1.5 x 3D camera accuracy
Working distance	2040 - 3240mm
3D camera weight	6.3kg
3D camera connection to PC	M12-8 (Ethernet)
Power supply	24V CC 2A max
Temperature Operational	0°C to 50°C
IP rating	IP65
Conforms to	CE, FCC and RoHS

* A larger FOV has lower 3D camera accuracy

** Average accuracy from the real production environment

CABLES AND POWER SUPPLY TECHNICAL SPECIFICATIONS

- **Ethernet cables** in 10m, 20m, 30m, with M12-8 right angle overmolded connector
- **Flex power cables** in 10m, 20m, 30m, with M12-5 right angle overmolded connector
- **Power supply** SNT-2403, 100-240V 50-60HZ 1.5A to 24V 3A CC

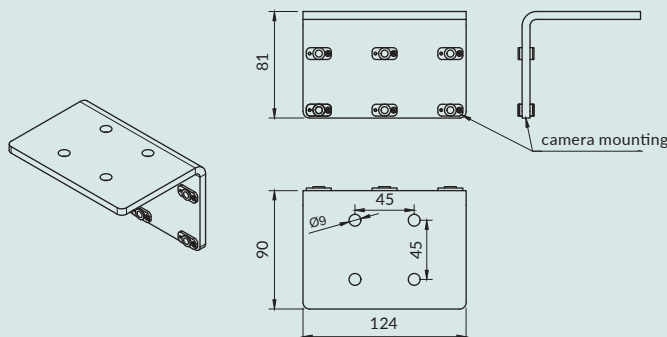

Dimensions in mm

MOUNTING BRACKET DRAWING

This mounting bracket is provided with the camera, please refer to the 4 holes for connecting it to a fixture.

USE PICKIT WITH THE ROBOT OF YOUR CHOICE

